

For Sale

18 Scott Place ORANGE

INDUSTRIAL LAND - LEEWOOD ESTATE

Orange is the largest urban area in Central West New South Wales, population circa 42,000.

The diversified regional economy of Orange is centred on mining, health services and government administration.

Location

Situated approximately 2.6 kilometres south of Orange CBD in Leewood Industrial Estate.

Description

Serviced level industrial land
Situated in Leewood Industrial Estate
Frontage to proposed Southern Distributor Road
Access from Scott Place
Other adjoining / nearby allotments also available - see plan over page

Land Area: 1,646 sqm

Zoning: IN1 General Industrial

Price: Contact agent

For more information please contact

David Hall
0429 656 101

Nigel Staniforth
0401 279 795

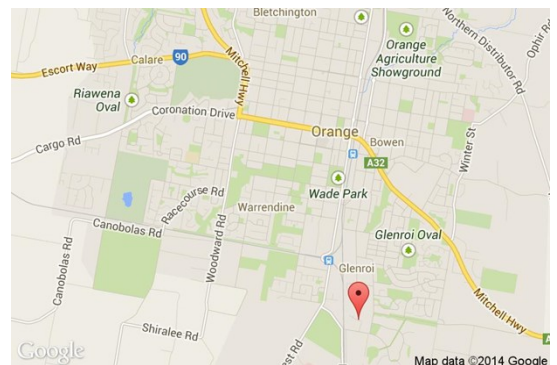
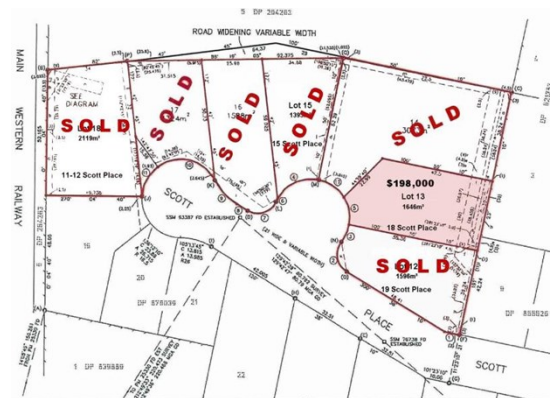

BENCHMARK
COMMERCIAL

194B Lords Place, Orange NSW 2800

Telephone: (02) 63 62 5988
Email: sales@bmpa.com.au
Web: www.bmpa.com.au

