

# For Lease

## 39 Peisley Street ORANGE

### PEISLEY STREET WAREHOUSE AND WORKSHOP

Orange is the largest urban area in Central West New South Wales, population circa 42,500.

The diversified regional economy of Orange is centred on mining, health services and government administration.

### Location

Situated approximately 1.3 kilometres south of Orange CBD in the busy Peisley Street service trades precinct.

### Description

Excellent location on Peisley Street  
Rear shed of complex  
Shared amenities  
New auto roller door, lighting and internal cladding

Warehouse Lighting: Mixed Configuration  
Roller Door Height: 3.10 metres  
Parking: 1 onsite  
3 Phase Electricity: Yes  
Secure Yard: Yes

Zoning: IN1 General Industrial

Tenancy	Offices Amenities m <sup>2</sup>	W'hse m <sup>2</sup>	Other m <sup>2</sup>	Total Bldg m <sup>2</sup>	Rent (Ex GST) \$/week	\$pa/m <sup>2</sup>	Net/ Gross
Shed Five		110		110	\$250	\$118	Gross

### For more information please contact

Nigel Staniforth  
0401 279 795

David Hall  
0429 656 101

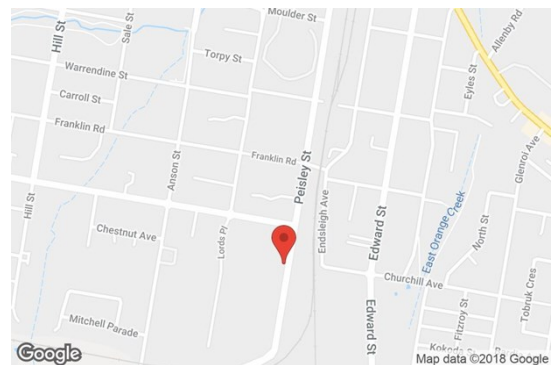

**BENCHMARK**  
COMMERCIAL

194B Lords Place, Orange NSW 2800

Telephone: (02) 63 62 5988  
Email: sales@bmpa.com.au  
Web: www.bmpa.com.au

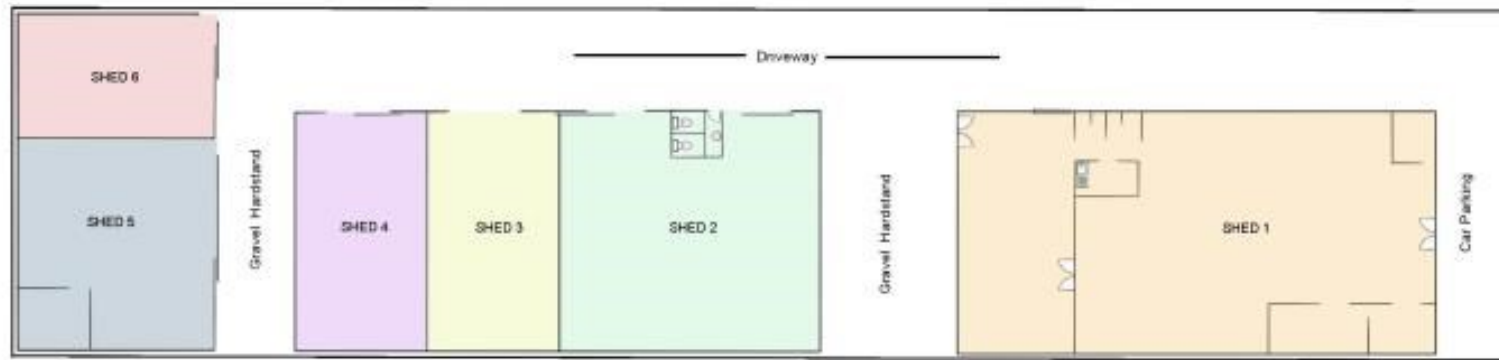

PEISLEY STREET