

For Lease

71 Kite Street ORANGE

MODERN CBD OFFICES

Orange is the largest urban area in Central West New South Wales, population circa 42,500.

The diversified regional economy of Orange is centred on mining, health services and government administration.

Location

Located on the northern side of Kite Street in the Orange CBD

Description

Centrally located office space
North facing rooms offer excellent natural light
Reverse cycle air-conditioning and security alarm system
Male, female and disabled amenities and kitchen facilities shared with adjoining tenancy
Separate entrance, data cabling and electricity metering
Additional adjoining 2 rooms also available by negotiation

Amenities: Shared
Ceiling: Plasterboard
Lighting: Fluorescent
Air Conditioning: Yes
Data Cabling: Yes
Security System: Yes

Parking: 2 on-site car parking spaces

Zoning: B3 Commercial Core



BENCHMARK
COMMERCIAL

194B Lords Place, Orange NSW 2800

Telephone: (02) 63 62 5988
Email: sales@bmpa.com.au
Web: www.bmpa.com.au

Tenancy	Area m ²	Rent (Ex GST)		Net/Gross
		\$pa	\$/Week	
Suite 2	79	\$30,000	\$577	Gross

For more information please contact

Nigel Staniforth
0401 279 795

David Hall
0429 656 101

Car Parking

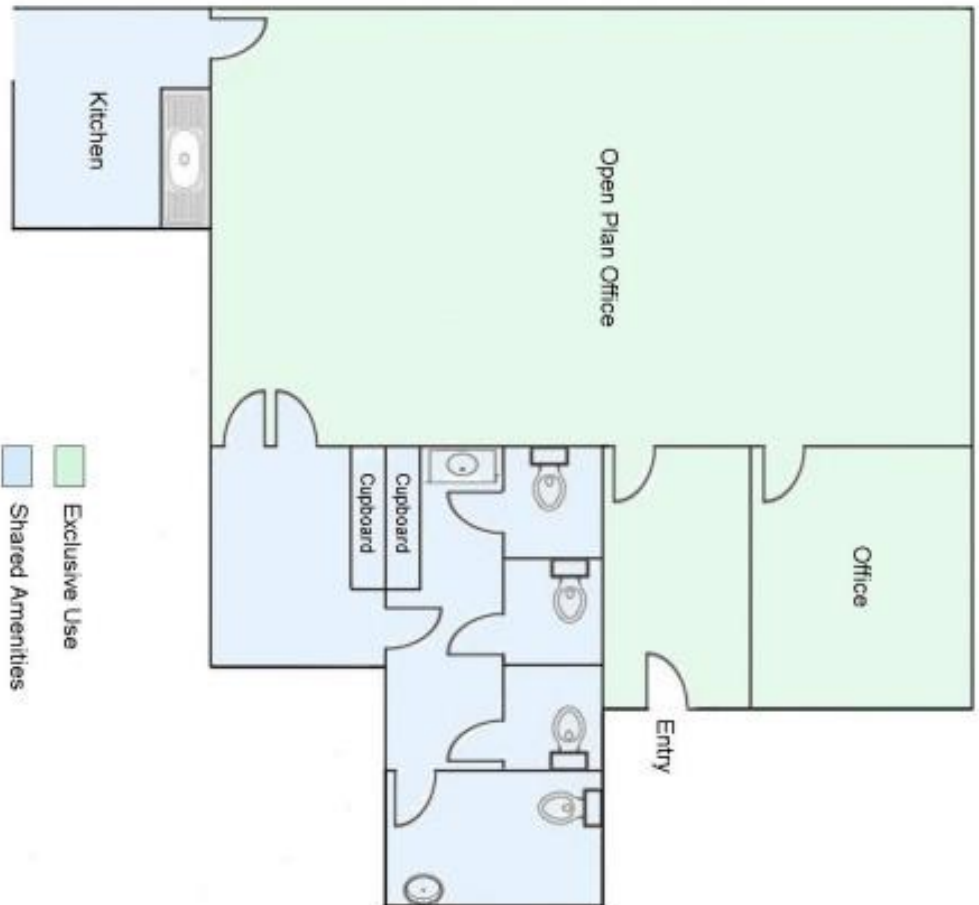

SUITE 2, 71 KITE STREET