

# For Lease

## McNamara House 60-62 McNamara Street ORANGE

### MODERN OFFICES IN CENTRE OF CBD

Orange is the largest urban area in Central West New South Wales, population circa 42,500.

The diversified regional economy of Orange is centred on mining, health services and government administration.

### Location

McNamara House is situated in the heart of Orange CBD in the retail, court house and civic precinct with stunning aspect and views across Robertson Park.

### Description

Prime position in the heart of the CBD overlooking Robertson Park with public car park adjoining at rear  
Modern office building with a history of blue-chip tenants/businesses

Lift + secure basement car parking  
Excellent natural light  
Quality existing fitout  
NABERS rating: 2

Amenities: Shared  
Ceiling: Grid  
Lighting: Fluorescent  
Air Conditioning: Yes  
Data Cabling: Yes  
Security System: Yes

Parking: Basement car parking by negotiation

Zoning: B3 Commercial Core

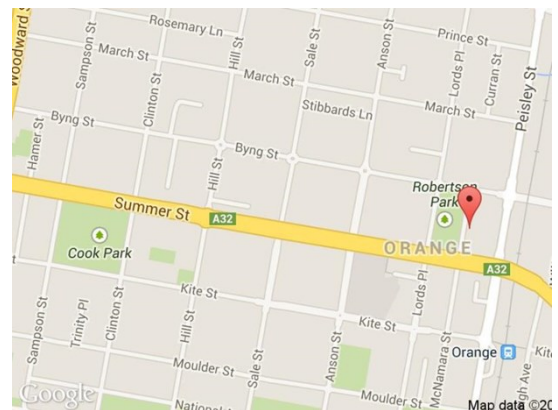
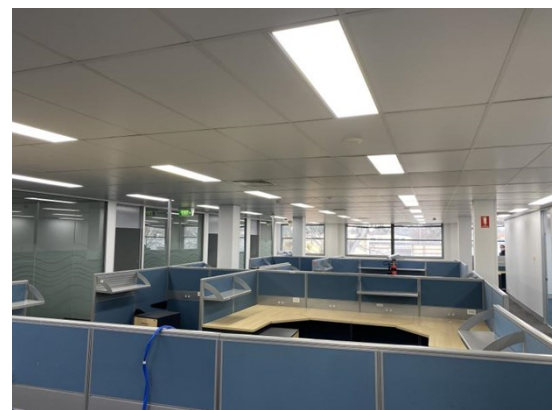

Tenancy	Area m <sup>2</sup>	Rent (Ex GST)		Net/Gross
		\$pa	\$/m <sup>2</sup>	
Level 1 Suite 3	508	\$194,000	\$382	Net

### For more information please contact

Nigel Staniforth  
0401 279 795

David Hall  
0429 656 101



**BENCHMARK**  
COMMERCIAL

194B Lords Place, Orange NSW 2800

Telephone: (02) 63 62 5988  
Email: sales@bmpa.com.au  
Web: www.bmpa.com.au

ALL AREAS AND FIGURES APPROX. ONLY. All precaution has been taken to establish the accuracy of the information contained in this brochure. It does not, however, constitute any representation by the Vendor or Agent.

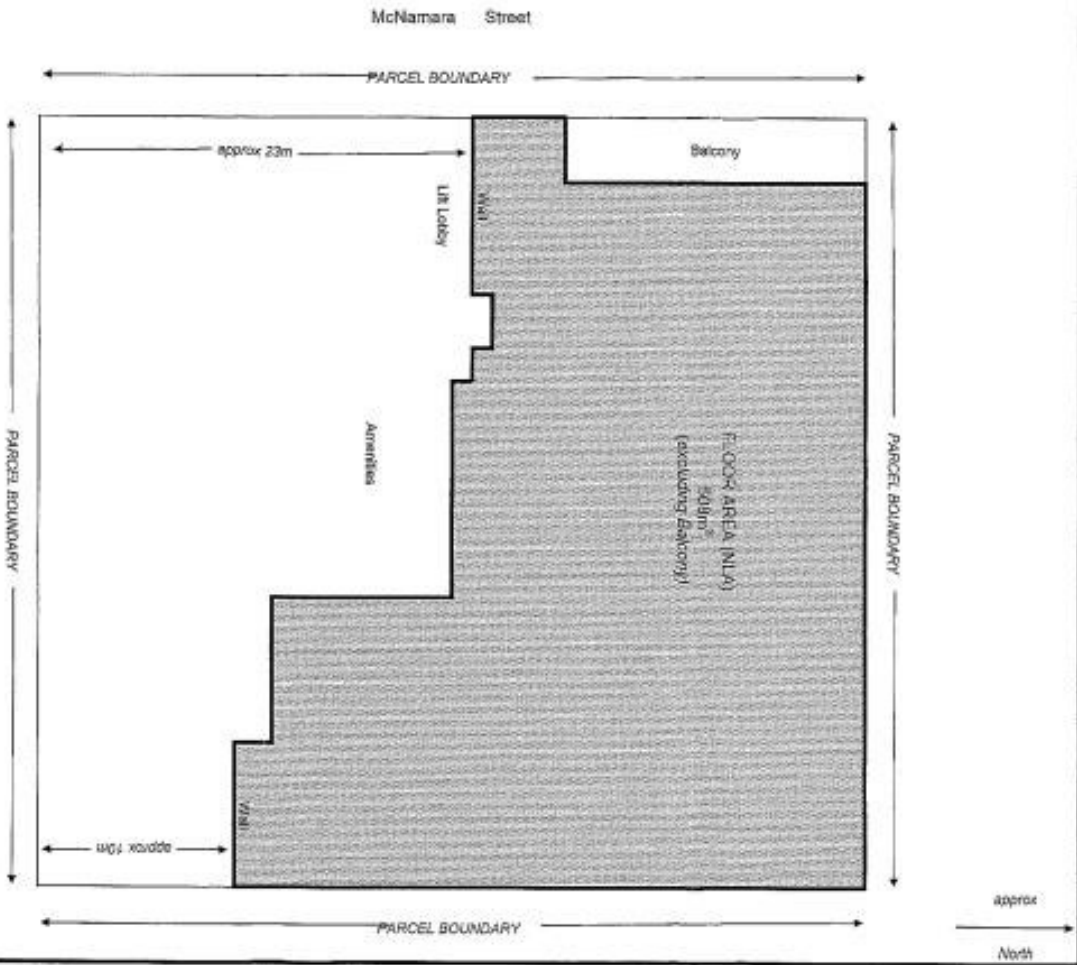

**NOT TO SCALE**

These premises are fully vested as per this plan

NOTE  
: (NLA) IS NET LETTABLE AREA  
: SURVEY MEASURED GENERALLY IN ACCORDANCE  
WITH PROPERTY COUNCIL OF AUSTRALIA GUIDELINES

REGISTERED SURVEYOR

GRAIG JACOBS & ASSOCIATES PTL

Land Surveying Consultants

P.O. Box

ORANGE NSW 2800

TEL: (02) 6362 1900

FAX: (02) 6362 4300

**PART 1ST FLOOR**

**60-62 McNAMARA STREET, ORANGE**

**CLIENT: CRAFTMORE PTY LIMITED**

LEVELS SHOWN ARE TO N/A DATUM

LSA ORANGE

DATE: 28/9/12

REF: 1624/12