

For Lease

185 Lords Place ORANGE

LORDS PLACE RETAIL OR OFFICES

Orange is the largest urban area in Central West New South Wales, population circa 42,500.

The diversified regional economy of Orange is centred on mining, health services and government administration.

Location

Situated on the western side of Lords Place between Summer Street and Kite street.

Description

Well located retail or office premises
Open plan retail space
Rear service/administration/storage area
Reverse cycle air-conditioning
Roller shutter security to shop front
on-site parking at rear

Retail Frontage: 7.5 metres
Amenities: Separate Male & Female
Ceiling: Grid
Lighting: Fluorescent
Air Conditioning: Yes

Parking: 4 on-site spaces

Zoning: B3 Commercial Core

Area m ²	Rent (Ex GST)		Net/Gross
	\$pa	\$/m ²	
270	\$55,521	\$206	Net

For more information please contact

David Hall
0429 656 101

Nigel Staniforth
0401 279 795



BENCHMARK
COMMERCIAL

194B Lords Place, Orange NSW 2800

Telephone: (02) 6362 5988
Email: sales@bmpa.com.au
Web: www.bmpa.com.au

LORDS PLACE

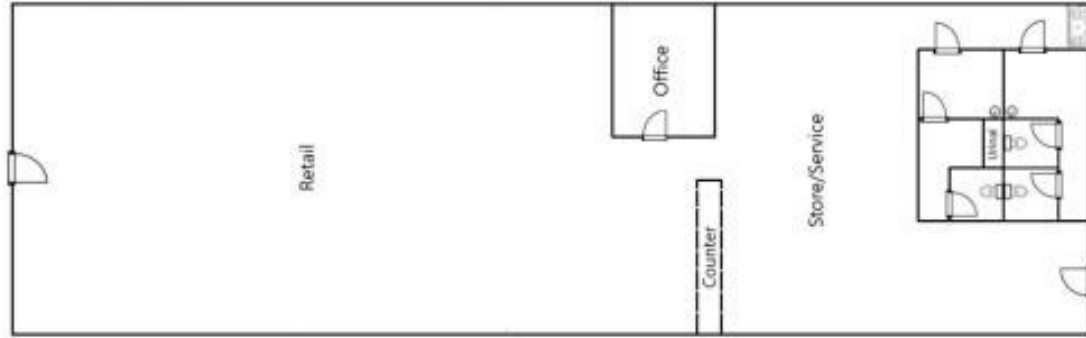

Parking